

**Girl Scouts of Western Washington**  
**Camp Towhee**  
 9010 Heady Rd.  
 Sumas, WA 98266  
**Driving Directions**

**Driving Directions from Seattle:**

- Go north on **I-5 to Cook Road Exit #232** (2.75 miles past the Anacortes exit).
- Turn east **(right) onto Cook Road** and follow 4.4 miles until it intersects with Highway 20 in Sedro Woolley
- Turn east **(left) onto Highway 20**, follow through Sedro Woolley to the intersection with Hwy 9, approximately 1.9 miles.
- Turn north **(left) and travel on Highway 9** approximately 23 miles to its intersection with Highway 542 (Mt. Baker Highway).
- Turn east **(right) on Hwy 542** and go 8.5 miles to intersection with Hwy 547 in Kendall (toward Sumas)
- Turn north **(left) on Hwy 547/Kendall Rd.** and follow as it loops to the north. Travel approximately 3.7 miles to the South Pass Road.
- Turn **east (right) on South Pass Road**, travel 1.0 miles to Heady Road
- Turn south **(right) on Heady Road**. Travel .25 miles to camp gate on left side of road.

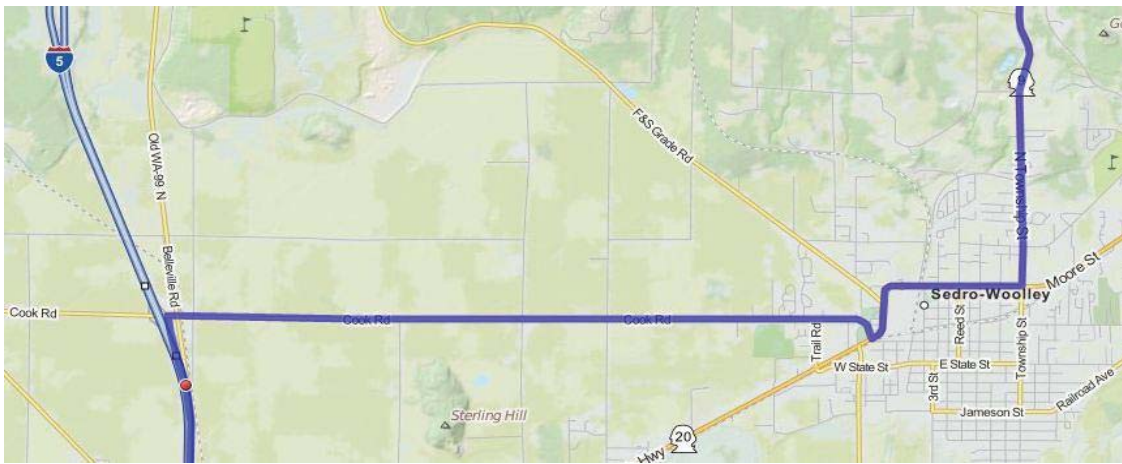

**Driving Directions from Bellingham:**

- Take **WA-542 E/Mt Baker Hwy east** for approximately 7.1 miles
- At the first traffic circle, continue straight and **stay on WA-542 E/Mt Baker Hwy** for 1.1 miles
- At the second traffic circle, continue straight through and **stay on WA-542/WA-9/Mt Baker Hwy**
- Continue to **follow WA-542/Mt Baker Hwy** for another 12.9 miles
- Turn north **(left) on Hwy 547/Kendall Rd.** and follow as it loops to the north. Travel approximately 3.7 miles to the South Pass Road.
- Turn **east (right) on South Pass Road**, travel 1.0 miles to Heady Road
- Turn south **(right) on Heady Road**. Travel .25 miles to camp gate on left side of road.

GIRL SCOUTS OF WESTERN WASHINGTON  
MAPLE FALLS PROPERTY

HEADY ROAD  
AND VICINITY

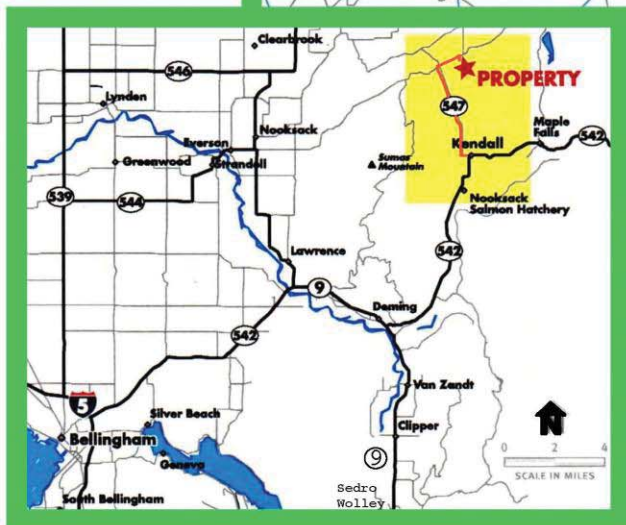
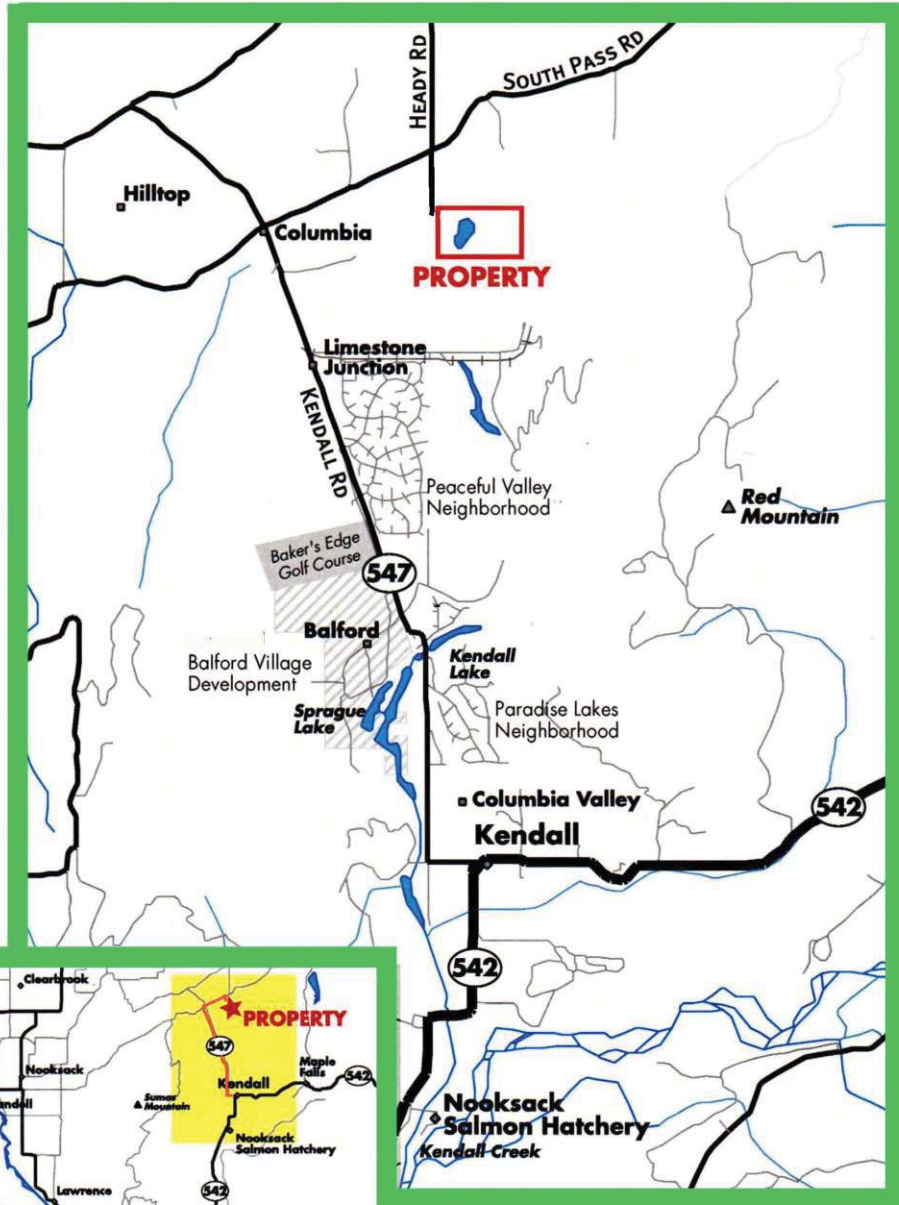

I 5 AND  
VICINITY



Picnic tables on gravel



Tent site

